



	
Client	Melrose Cranes
Location	Dalley St, Sydney
Date	12/01/2023
Scope	Full Closure - Mobile Crane
Author	Jessica Lemros
License #	TCT1002557
Plan #	1

Notes:

- Full road closure for mobile crane set up
- Traffic controllers to maintain communication at all times to allow local traffic access and assist with vehicles exiting from Underwood St & Queens Ct.
- Pedestrians to be redirected under traffic control assistance
- Detour plan to be in place at all times.
- TGS 1 & 2 to be implemented simultaneously.
- Radio communication at all times.

- Manifest**
- 3 x T2-4 ROAD CLOSED
 - 3 x Traffic Controller
 - 2 x R2-6 (R) NO RIGHT TURN NSW
 - 2 x T1-18 PREPARE TO STOP
 - 2 x T1-200-2 TRAFFIC CONTROLLER AHEAD
 - 2 x T1-32 SIDE ROAD CLOSED
 - 2 x T1-5-2 WORKERS AHEAD NSW
 - 1 x Crane 5 Axle
 - 1 x Semi Trailer
 - 1 x T5-1 (L) DETOUR LEFT
 - 1 x T5-1 (R) DETOUR LEFT
 - 1 x T8-3 USE OTHER FOOTPATH
 - 1 x TM2-V103 LOCAL ACCESS ONLY

Traffic control warning signs and devices must be implemented and operated in accordance with AS1742-2:2009 (manual of traffic control devices) and RMS NSW TCAMS-V6 technical manual (traffic control at work sites)

Detour Plan

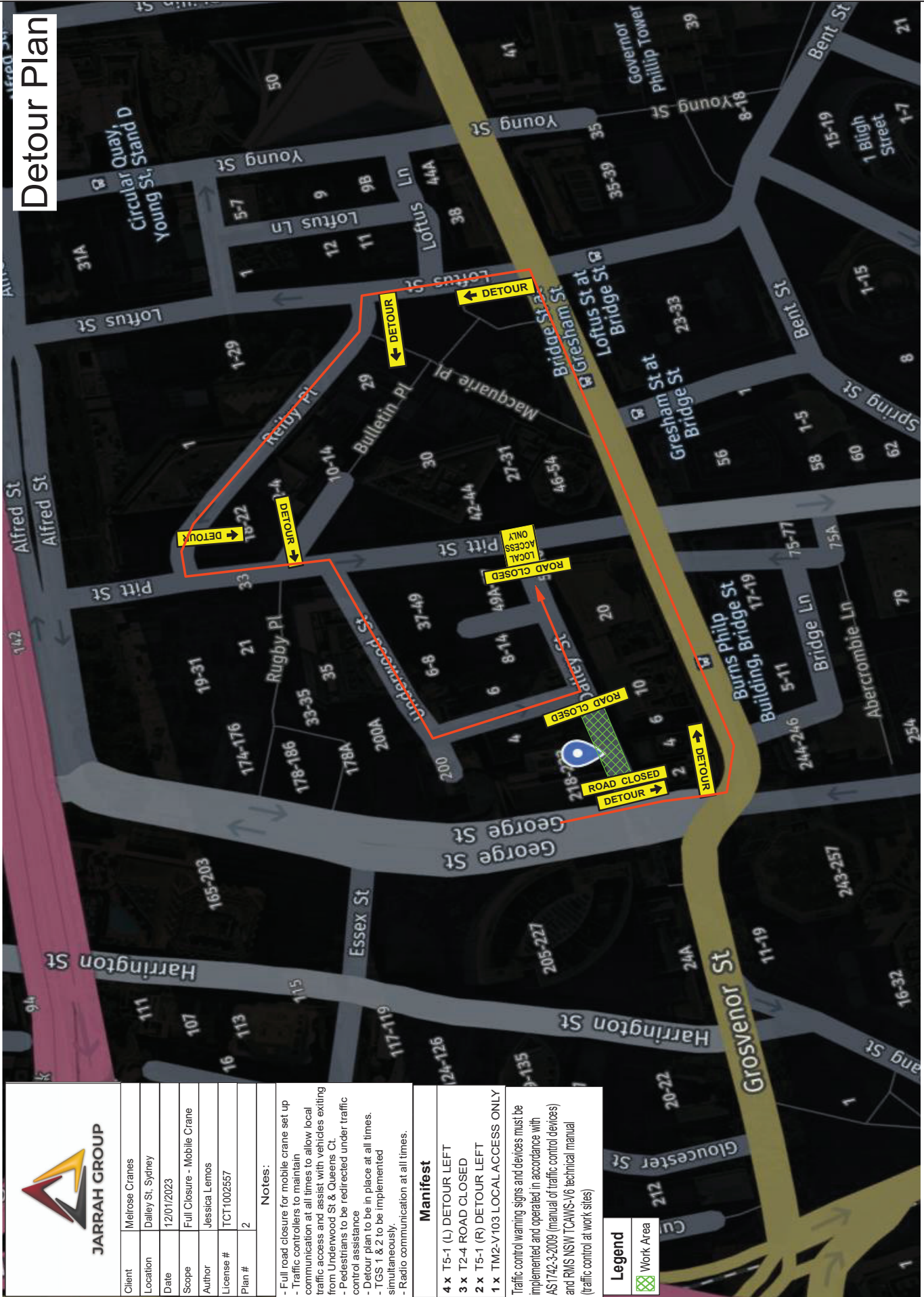

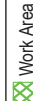
 JARRAH GROUP	
Client	Melrose Cranes
Location	Dalley St, Sydney
Date	12/01/2023
Scope	Full Closure - Mobile Crane
Author	Jessica Lemos
License #	TCT002557
Plan #	2
Notes:	<ul style="list-style-type: none"> - Full road closure for mobile crane set up - Traffic controllers to maintain communication at all times to allow local traffic access and assist with vehicles exiting from Urdenwood St & Queens Ct - Pedestrians to be redirected under traffic control assistance - Detour plan to be in place at all times. - TGS 1 & 2 to be implemented simultaneously. - Radio communication at all times.
Manifest	<ul style="list-style-type: none"> 4 x T5-1 (L) DETOUR LEFT 3 x T2-4 ROAD CLOSED 2 x T5-1 (R) DETOUR LEFT 1 x TM2-V103 LOCAL ACCESS ONLY <p>Traffic control warning signs and devices must be implemented and operated in accordance with AS1742-3:2009 (manual of traffic control devices) and RMS NSW TCAMS-V6 technical manual (traffic control at work sites)</p>
Legend	 Work Area